

Notes:

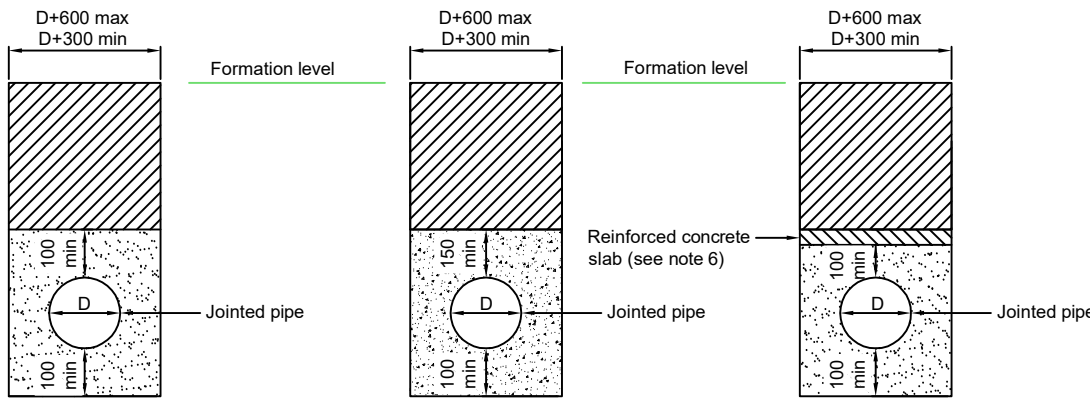

Key:

- Type 1 sub-base or 6F2 capping compacted in 225 layers
- Granular pipe bedding to MCHW CL503-3(i)
- Concrete bedding - GEN1 Mix B or C see Note 11
- Formation level

Table 1

1. All dimensions are in millimetres unless shown otherwise.
2. Acceptable pipe materials shall be :
 - a) Vitrified clay pipes to BS 65
 - b) Concrete pipes to BS EN 1916.
 - c) Thermoplastic pipes to MCHW Clause 518 (minimum SDR34).
3. Pipe and bedding and materials must not be changed between chambers.
4. Saddle connections may only be used with the approval of the Oxon Engineer.
5. Culverts with b or pipes with D greater than 900 must comply with the requirements of DMRB CG300.
6. C25/30 strength mix to be designed by Engineer
7. Box culverts shall be designed in accordance with CD529 for maintenance and screening requirements.
8. The minimum culvert diameter should be 450mm unless agreed with an OCC engineer. Where a culvert is longer than 12m, it shall have a minimum span/height of 1.2m in accordance with CD529.
9. Reinforced concrete for box culverts to be designed by others.
10. For further information refer to Standard Details Guidance Note drawing no. HSD/100/001
11. For concrete specifications and mix information refer to the Concrete For Ancillary Purposes Standard Specification drawing no. HSD/100/002."

CARRIAGEWAY, CYCLEWAY & FOOTWAY DRAIN TYPE D2 ALL PIPES

Less than 1200 cover

CARRIAGEWAY, CYCLEWAY & FOOTWAY DRAIN TYPE D3 CONCRETE, CLAY OR PLASTIC

Less than 1200 cover

CARRIAGEWAY, CYCLEWAY & FOOTWAY DRAIN TYPE D4 CONCRETE, CLAY OR PLASTIC

Less than 1200 cover
Concrete slab alternative to concrete surround

Pipe diameter	Thickness of compressible board or joint filler
less than 450	18
450 - 1200	36
over 1200	54

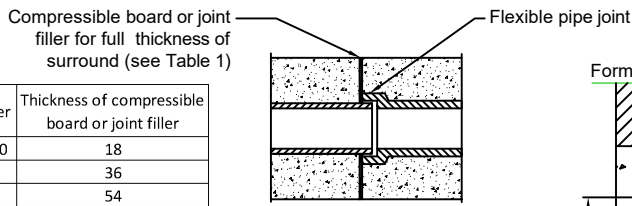

FLEXIBLE JOINT FOR CONCRETE SURROUND (reinforced slab similar)

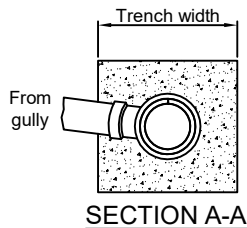

GULLY CONNECTION DETAILS

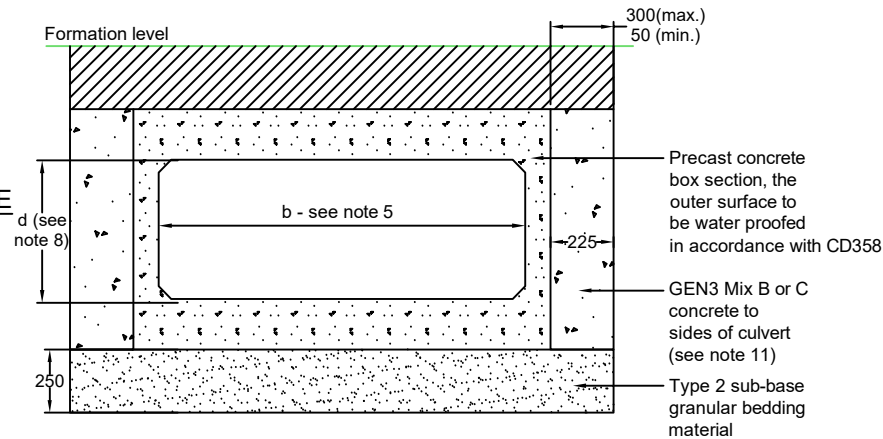
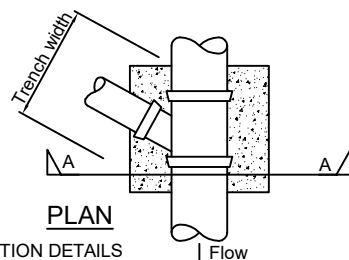

DESIGN GROUP D1 CULVERT WITH FLEXIBLE JOINTS (See note 8 & 9)

DRAWING TITLE:
Series 500: Drainage and Service Ducts: Sewers and Drains - Under Paved Areas, and within 1m of Paved Areas

SCALE: NTS

DRAWN	CHECKED
INITIALS: CS	MS
DATE: 12/01/2024	12/01/2024

REV	AMENDMENTS	DRN	CHCK'D

DRAWING NO:
HSD/500/010

