

**HALF BATTER
HB2 KERB**

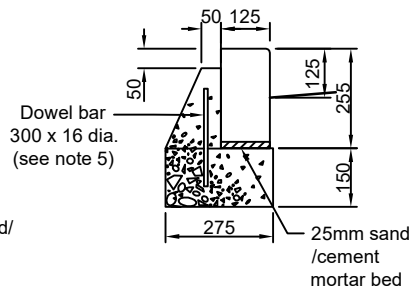

**BULL NOSED
125x255 BN**

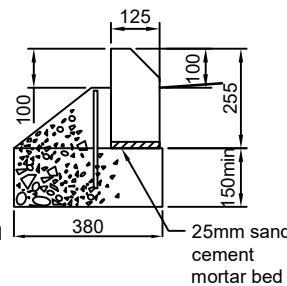

**45° SPLAY
SP KERB**

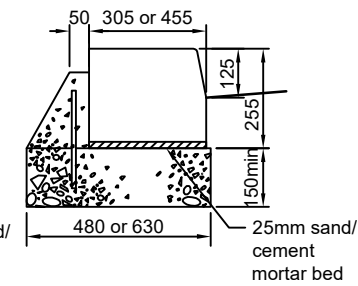

**QUADRANT
QHB2 KERB**

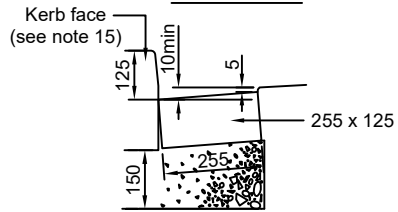

**SQUARE CHANNEL
CS1 - AGAINST KERB**

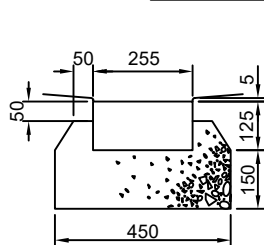

**SQUARE CHANNEL
- CS1**

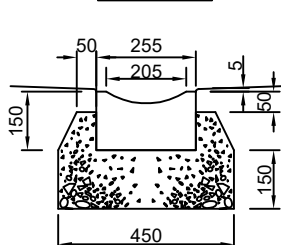

**DISHED CHANNEL - CD
(FOOTWAYS ONLY)**

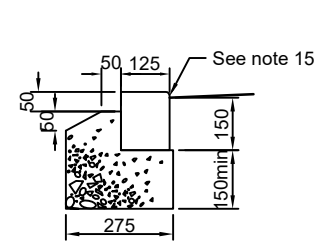

**BULL NOSED
125x150 BN**

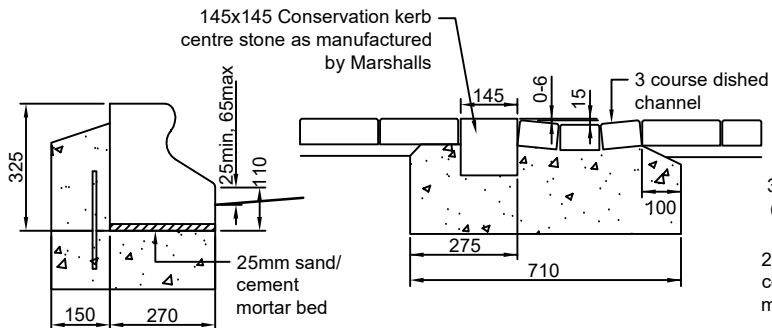

MINI TRIEF

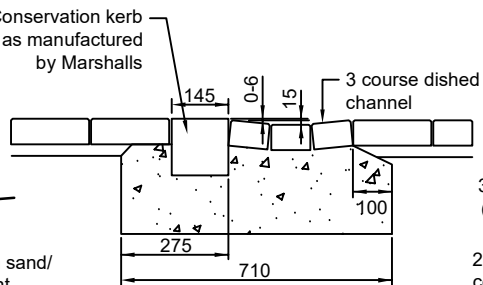

CONCRETE BLOCK DISHED CHANNEL

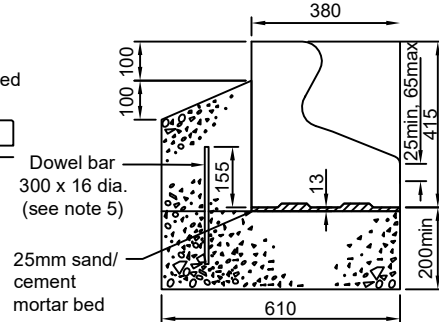

**SAFETY KERB
GST/2A**

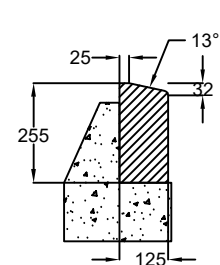

CAMBRIDGE KERB

Notes:

- All dimensions are in millimetres unless shown otherwise.
- All in-situ concrete bedding and haunching to be GEN1 Mix B or C concrete. For concrete specifications and mix information refer to the Concrete For Ancillary Purposes Standard Specification drawing no. HSD/100/002.
- Kerb and edging foundation to be laid on rolled sub-base of minimum thickness 150.
- The kerb bed and backing shall normally be laid in one operation.
- Dowel bars may be required in backing to standard kerbs in circumstances where the kerbs are vulnerable.
- 300 x 16 dia dowel bars at 450 centres must be used with Safety Kerbs unless the backing concrete is brought level with top of kerb. The reinforcement and 2 stage kerb bed and backing is only required when used for industrial situation where HGV traffic is likely.
- Kerbs shall be laid with dry joints and closely butted to adjacent kerbs and channels.
- Transition kerbs to be used at all changes in kerb face.
- For radii of 12m or less kerbs and channels of the appropriate radius shall be used.
- For radii between 12m and 18m straight kerbs 600 long shall be used.
- Cutting of kerbs and channels shall be by approved mechanical means.
- The length of any kerb or channel shall not be less than 300.
- Where channel blocks are laid to false falls the kerb face must be 100 min - 150 max.
- All kerbing supporting verge areas shall provide for 100 min depth of topsoil (similar to as shown for SP kerb).
- Kerb face of dropped crossings:
Cycle crossing: 0-6mm
Pedestrian crossing: 0-6mm
Vehicle crossings: 25mm.
- For further information refer to Standard Details Guidance Note drawing no. HSD/100/001

DRAWING TITLE:
Series 1100: Kerbs, Footways and Paved Areas - Concrete Kerbs and Channels

SCALE: NTS
DRAWN: CS
CHECKED: MS
DATE: 12/01/2024

REV	AMENDMENTS	DRN	CHK'D	DATE
DRAWING NO: HSD/1100/060				

