

RECEIVED  
24 DEC 2003

FORM A

APPLICATION FORM  
FOR A MODIFICATION TO THE DEFINITIVE MAP AND STATEMENT  
Wildlife and Countryside Act 1981

To: Public Rights of Way Office, Countryside Service, Environment & Economy, Oxfordshire County Council, Central Library, Westgate, Oxford OX1 1DJ

1/We\*(i) CHINNOR PARISH COUNCIL  
of (ii) COUNCIL OFFICE, THE VILLAGE CENTRE, HIGH ST. CHINNOR,

hereby apply for an order under Section 53(2) of the Wildlife and Countryside Act 1981 modifying the Definitive Map and Statement for the area by (iii):- OK39 4DH

- (a) ~~Deleting~~ the ~~footpath / bridleway / byway open to all traffic \*~~ which runs  
from: \_\_\_\_\_  
to: \_\_\_\_\_
- (b) ~~Adding~~ the ~~footpath / bridleway / byway open to all traffic \*~~ which runs  
from: GREENWOOD AVENUE, CHINNOR  
to: ST. ANDREW'S ROAD, CHINNOR
- (c) ~~Upgrading/downgrading~~ to a ~~footpath / bridleway / byway open to all traffic \*~~ the ~~footpath/bridleway/byway open to all traffic~~ which runs  
from: \_\_\_\_\_  
to: \_\_\_\_\_
- (d) ~~Varying/adding~~ to the particulars relating to the ~~footpath / bridleway / byway open to all traffic \*~~  
from: \_\_\_\_\_  
to: \_\_\_\_\_  
by providing that \_\_\_\_\_

and shown on the map annexed hereto (see overleaf).

The approximate width of the right of way is 6' max; 3foot minimum

We ~~are~~ attach copies of the following documentary evidence [including statements of witnesses] in support of this application:- (Please list documents and continue on a separate sheet if necessary)

- (iv) USER EVIDENCE FORMS.  
STATEMENTS OF WITNESSES

This application form and the details contained therein will be considered by Oxfordshire County Council and will be disseminated widely for these purposes and made available to the public.

Signed: [REDACTED] Date: 19/12/03

(i) Insert name of applicant(s)      (iii) Delete as appropriate      \* Delete as appropriate  
(ii) Insert address of applicant(s)      (iv) Insert list of documents

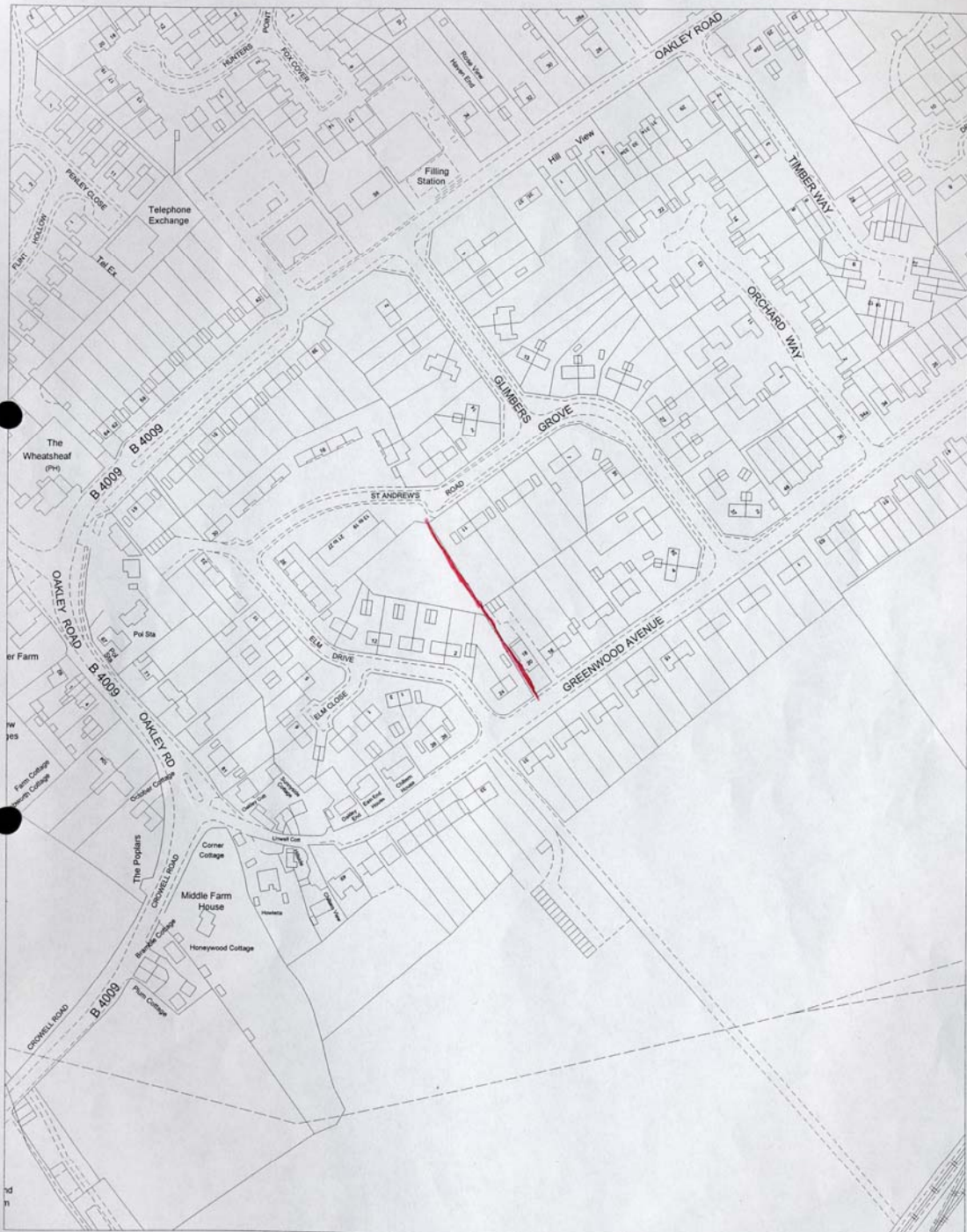

Reproduced from the Ordnance Survey mapping with the permission of the Controller of Her Majesty's Stationery Office Crown Copyright. Unauthorised reproduction infringes Crown copyright and may lead to prosecution or civil proceedings.  
Oxfordshire County Council Licence Number LA076805

Scale 1:2500  
Plot Date: 6 May 2003  
Drawn By: KT